



Wah Wang Data Sheet for LED Module

WW-CI30 Green Color Water Proof Series



**Address : Unit 03B, 18th Floor, Nanyang Plaza,
No. 57 Hung To Road, Kwun Tong
Kowloon, Hong Kong**

Tel : 852-2512 9939 (10 line)

Fax : 852-2344 2398

Web Site : www.wahwang.com



Wah Wang Data Sheet for LED Module WW-CI30 Green Color Water Proof Series

Dimension Drawing

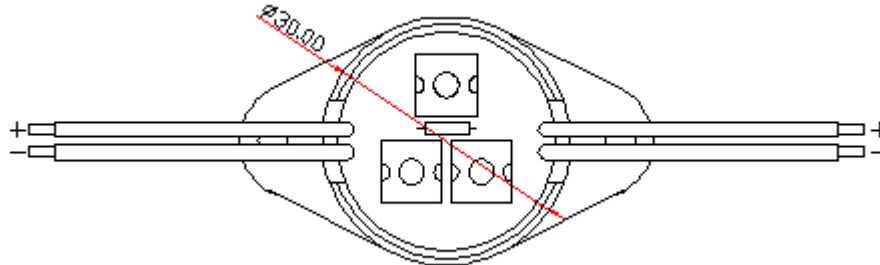

Part Number	WW-CI3003V0SGI4A03
Dimension	30 x 30 x 12mm
Weight	14g±5%
Airproof Colloid color	Water Clear
Rated Voltage	DC12V±5%
Rated Current	0.03A
Rated Power	0.3W
Luminous Flux	9lm
Waving Angle	>120°
IP Grade	IP68
Using Environment	Indoor or Outdoor
Module Interface	Grey 0.75mm ² ×60mm RV Lead
Interface Define	Grey Anode, White Cathode
Module Distance	60mm±5%
Notes: <ol style="list-style-type: none">All dimensions are in millimeter.Tolerance of measurement is ±0.25mm(.01") unless others otherwise noted.Tolerance of measurement of luminous intensity is ±15%$\theta_{1/2}$ is the off-axis angle at which the luminous intensity is half the axial luminous intensity. Tolerance of measurement of angle is ±10 degreeCaution in ESD: Static Electricity and surge damages the LED. It is recommended to use a wrist band or anti-electrostatic glove when handling the LED. All devices, equipment and machinery must be properly grounded.The dominant wavelength λ_d is derived from the CIE chromaticity diagram and represents the single wavelength which defines the color of the device.Specifications are subject to change without notice.	

CAUTIONS

- Storage
 - The LED Module should be stored at stored at 30°C or less and 70%RH or less after being shipped and the storage life limits are 3 months.
 - If the LED Module is stored more then 3 months, they can be stored for a year in a sealed container with a nitrogen atmosphere and moisture absorbent material.
 - Please avoid rapid transitions in ambient temperature, especially, in high humidity environments where condensation can occur.
- Static Electricity
 - Static electricity or surge voltage damages the LED Module.
 - It is recommended that a wristband or an anti-electrostatic glove be used when handling the LED Module.
 - All devices, equipment and machinery must be properly grounded.
 - It is recommended that measures be taken against surge voltage to the equipment that mounts the LED Module
- Heat Generation
 - Thermal design of the end product was most importance. Please consider the heat generation of the LED Module when making the system design.
 - The thermal resistance of the circuit board and density of LED Module placement on the board, as well as other components was the important factor affecting the coefficient of temperature increase per input electric power.
 - It must be avoid intense heat generation and operate within the maximum ratings given in the specification.
 - The operating current should be decided after considering the ambient maximum temperature of LED Module.
- Others
 - Care must be taken to ensure that the reverse voltage will not exceed the absolute maximum rating when using the LED Module with matrix drive.
 - The LED Module described in this brochure is intended to be used for ordinary electronic equipment (such as office equipment, communications equipment, measurement instruments and household appliances). Consult Wah Wang's sales staff in advance for information on the applications in which exceptional quality and reliability are required, particularly when the failure or malfunction of the LED Module may directly jeopardize life or health (such as for airplanes, aerospace, submersible repeaters, nuclear reactor control systems, automobiles, traffic control equipment, life support systems and safety devices).
 - User shall not reverse engineer by disassembling or analysis of the LED Module without having prior written consent from Wah Wang. When defective LED Module is found, the User shall inform Wah Wang directly before disassembling or analysis.
 - The formal specifications must be exchanged and signed by both parties before large volume purchase begins.
 - The appearance and specifications of the product may be modified for improvement without notice.